

Resitec - Typ RS 405d, DN 60

Massblatt / fiche technique des mesures

mit Schlitzrost barfuss
begehrbar

caillebotis avec fentes
traversée pied nus

RS405d.60.2.245

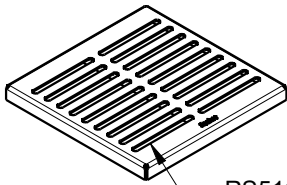

RS511.2.239

mit Lochrost 6 mm
befahrbar

grille perforée 6 mm
carrossable

RS405d.60.6.245

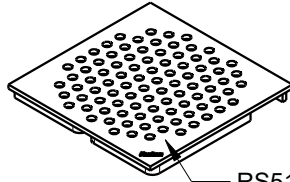

RS512.6.239

mit Gitterrost
befahrbar

grille caillebotis
carrossable

RS405d.60.G.245

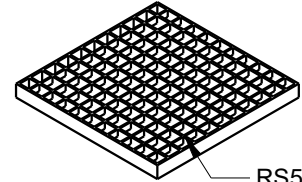

RS513A.239

RS03 / Rost verschraubt / grille vissée

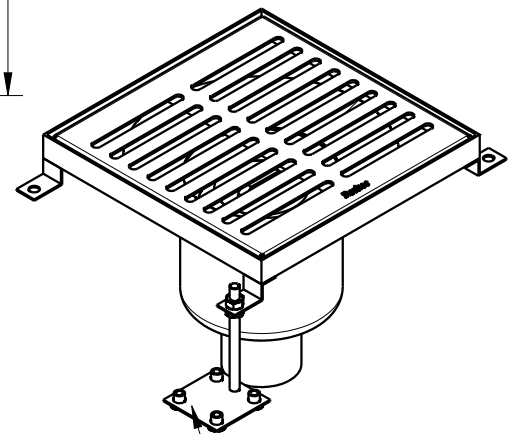
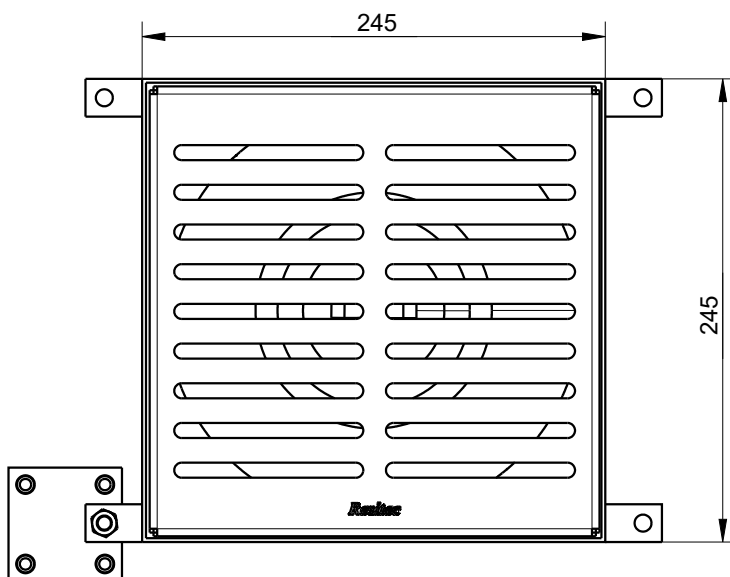
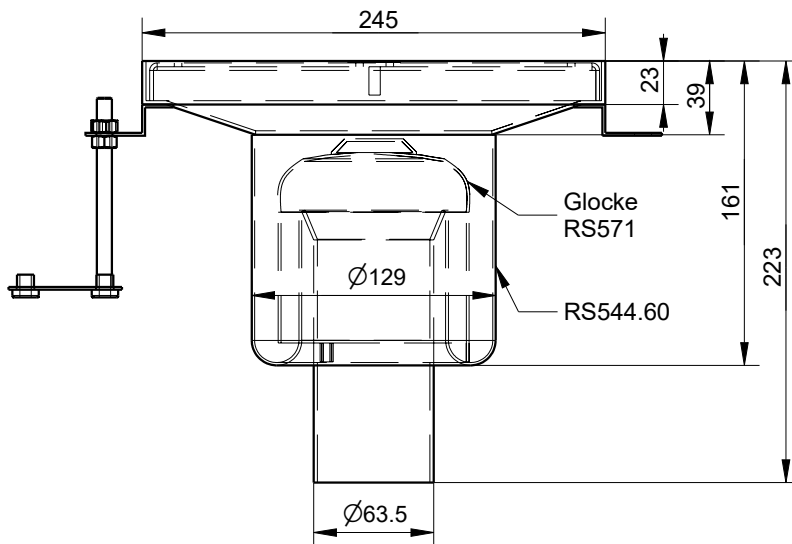

Montageset Typ I
RS050.100



- Rückstaudichtung RS644.60
joint de refoulement RS644.60
- Übergangsbride
Collier d'union intermédiaire